

# 永磁直行星齿轮电机 (内齿圈材质: 金属和粉末金属)

## PM DC Planetary Gear Motor (Ring Gear Material: Metal and Powder Metal)

### 42JXE100K/42ZY68P(1)

Φ42行星减速器, 允许转矩范围: 1N.m~10N.m  
42mm OD Planetary Gearbox,  
Permissible Load Range: 1N.m~10N.m

可在两种材料的内齿圈中进行选择: 粉末金属 (型号42JXF100K), 金属 (型号42JXE100K)。  
Ring gear can be selected within the two materials: Powder metal (Type:42JXF100K), Metal (Type:42JXE100K).

### ● 外形和安装尺寸 Dimensions

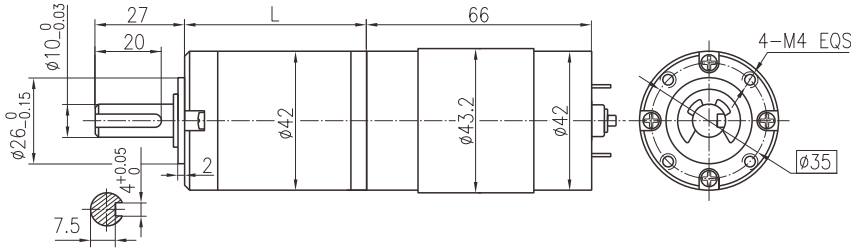

### ● 电动机主要技术参数 Motor Technical Data

电机型号 Type	额定电压 Rated voltage VDC	空载转速 No-load speed r/min	空载电流 No-load current A	额定转速 Rated speed r/min	额定转矩 Rated torque mN.m	输出功率 Output power W	额定电流 Rated current A	堵转力矩 Stall torque mN.m	堵转电流 Stall current A
42ZY68P-2430	24	3000	0.35	2250	66	16	1.2	200	3.1
42ZY68P-2440	24	4000	0.45	3000	85	27	2.1	250	5.0
42ZY68P-2450	24	5000	0.50	3750	115	45	3.1	305	8.0

### ● 齿轮减速电机主要技术参数 Gear Motor Technical Data

配置42ZY68P-2430直流电机 (42ZY68P-2430 DC Motor)

减速比 Reduction ratio	3.7	5.2	14	19	27	51	71	100	115	139	181	219	254	306	354
减速级数 Number of gear trains	1	1	2	2	2	3	3	3	3	3	4	4	4	4	4
减速器长度(L) Length(L) mm	31.5	31.5	42.1	42.1	42.1	52.5	52.5	52.5	52.5	52.5	62.9	62.9	62.9	62.9	62.9
空载转速 No-load speed r/min	809	579	214	158	111	59	42	30	26	22	17	14	11	9.8	8.5
额定转速 Rated speed r/min	606	434	161	118	83	44	32	23	20	16	12	10	8.9	7.4	6.4
额定转矩 Rated torque N.m	0.17	0.24	0.59	0.80	1.1	1.9	2.7	3.8	4.4	5.3	6.1	7.4	8.6	10	10
最大瞬间允许负载 Max. permissible load in a short time N.m	3	3	12	12	12	25	25	25	25	25	30	30	30	30	30

配置42ZY68P-2440直流电机 (42ZY68P-2440 DC Motor)

减速比 Reduction ratio	3.7	5.2	14	19	27	51	71	100	115	139	181	219	254
减速级数 Number of gear trains	1	1	2	2	2	3	3	3	3	3	4	4	4
减速器长度(L) Length(L) mm	31.5	31.5	42.1	42.1	42.1	52.5	52.5	52.5	52.5	52.5	62.9	62.9	62.9
空载转速 No-load speed r/min	1078	772	286	211	148	78	56	40	35	29	22	18	16
额定转速 Rated speed r/min	809	579	214	158	111	59	42	30	26	22	17	14	11
额定转矩 Rated torque N.m	0.31	0.43	1.0	1.4	2.0	3.4	4.8	6.7	7.7	9.3	10	10	10
最大瞬间允许负载 Max. permissible load in a short time N.m	3	3	12	12	12	25	25	25	25	25	30	30	30

配置42ZY68P-2450直流电机 (42ZY68P-2450 DC Motor)

减速比 Reduction ratio	3.7	5.2	14	19	27	51	71	100	115	139	181	219	254
减速级数 Number of gear trains	1	1	2	2	2	3	3	3	3	3	4	4	4
减速器长度(L) Length(L) mm	31.5	31.5	42.1	42.1	42.1	52.5	52.5	52.5	52.5	52.5	62.9	62.9	62.9
空载转速 No-load speed r/min	1348	965	357	263	185	98	70	50	43	36	28	23	20
额定转速 Rated speed r/min	1011	724	268	197	139	74	53	38	33	27	21	17	15
额定转矩 Rated torque N.m	0.38	0.54	1.3	1.8	2.5	4.3	6.0	8.4	9.7	10	10	10	10
最大瞬间允许负载 Max. permissible load in a short time N.m	3	3	12	12	12	25	25	25	25	25	30	30	30