

永磁直行星齿轮电机 (内齿圈材质: 粉末金属)

PM DC Planetary Gear Motor (Ring Gear Material: Powder Metal)

22JXF3K/24ZY30

Φ22行星减速器, 允许转矩范围: 0.03N.m~0.3N.m
22mm OD Planetary Gearbox,
Permissible Load Range: 0.03N.m~0.3N.m

● 外形和安装尺寸 Dimensions

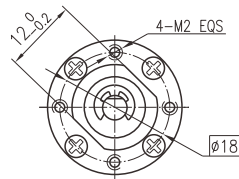
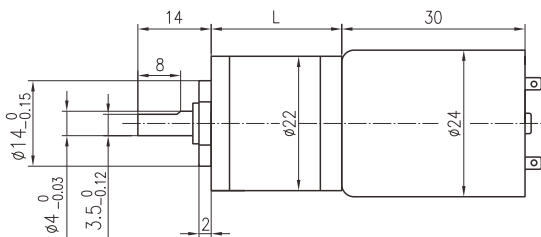

● 电动机主要技术参数 Motor Technical Data

电机型号 Type	额定电压 Rated voltage VDC	空载转速 No-load speed r/min	空载电流 No-load current mA	额定转速 Rated speed r/min	额定转矩 Rated torque mN.m	输出功率 Output power W	额定电流 Rated current mA	堵转力矩 Stall torque mN.m	堵转电流 Stall current A
24ZY30-1260	12	6000	70	4800	3	1.5	240	15	1.0
24ZY30-1280	12	8000	80	6500	3	2.0	300	16	1.2

● 齿轮减速电机主要技术参数 Gear Motor Technical Data

配置24ZY30-1260直流电机 (24ZY30-1260 DC Motor)

减速比	Reduction ratio	4	4.75	16	19	22	64	76	90	107	256	304	364	429	509
减速级数	Number of gear trains	1	1	2	2	2	3	3	3	3	4	4	4	4	4
减速器长度(L)	Length(L)	mm	13.0	13.0	16.7	16.7	16.7	20.4	20.4	20.4	24.1	24.1	24.1	24.1	24.1
空载转速	No-load speed	r/min	1500	1263	375	316	273	94	79	67	56	23	20	17	14
额定转速	Rated speed	r/min	1200	1011	300	253	218	75	63	53	45	19	16	13	11
额定转矩	Rated torque	N.m	0.011	0.013	0.039	0.046	0.053	0.14	0.17	0.20	0.23	0.3	0.3	0.3	0.3
最大瞬间允许负载 Max. permissible load in a short time	N.m		0.09	0.09	0.45	0.45	0.45	0.75	0.75	0.75	0.75	0.75	0.9	0.9	0.9

配置24ZY30-1280直流电机 (24ZY30-1280 DC Motor)

减速比	Reduction ratio	4	4.75	16	19	22	64	76	90	107	256	304	364	429	509
减速级数	Number of gear trains	1	1	2	2	2	3	3	3	3	4	4	4	4	4
减速器长度(L)	Length(L)	mm	13.0	13.0	16.7	16.7	16.7	20.4	20.4	20.4	24.1	24.1	24.1	24.1	24.1
空载转速	No-load speed	r/min	2000	1684	500	421	364	125	105	89	75	31	26	22	19
额定转速	Rated speed	r/min	1625	1368	406	342	295	102	86	72	61	25	21	18	15
额定转矩	Rated torque	N.m	0.011	0.013	0.039	0.046	0.053	0.14	0.17	0.20	0.23	0.3	0.3	0.3	0.3
最大瞬间允许负载 Max. permissible load in a short time	N.m		0.09	0.09	0.45	0.45	0.45	0.75	0.75	0.75	0.75	0.75	0.9	0.9	0.9

● 电动机特性图 Motor Characteristic Figure

