

永磁直行星齿轮电机 (内齿圈材质: 金属)

PM DC Planetary Gear Motor (Ring Gear Material: Metal)

60JX450K/63ZY125

Φ60行星减速器, 允许转矩范围: 4N.m~45N.m
60mm OD Planetary Gearbox,
Permissible Load Range: 4N.m~45N.m

● 外形和安装尺寸 Dimensions

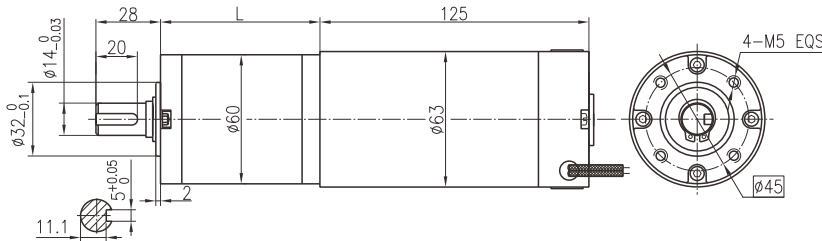

● 电动机主要技术参数 Motor Technical Data

电机型号 Type	额定电压 Rated voltage VDC	空载转速 No-load speed r/min	空载电流 No-load current A	额定转速 Rated speed r/min	额定转矩 Rated torque N.m	输出功率 Output power W	额定电流 Rated current A	堵转力矩 Stall torque N.m	堵转电流 Stall current A
63ZY125-2435	24	3500	0.8	2800	0.32	95	6.0	1.1	19
63ZY125-2450	24	5000	1.2	4000	0.38	159	9.5	1.5	32

● 齿轮减速电机主要技术参数 Gear Motor Technical Data

配置63ZY125-2435直流电机 (63ZY125-2435 DC Motor)

减速比 Reduction ratio	3.6	4.25	13	15	18	23	28	43	52	61	72	96	121	154	187	220	260
减速级数 Number of gear trains	1	1	2	2	2	2	2	3	3	3	3	3	3	4	4	4	4
减速器长度(L) Length(L) mm	40.3	40.3	53.8	53.8	53.8	53.8	53.8	67.2	67.2	67.2	67.2	67.2	67.2	80.6	80.6	80.6	80.6
空载转速 No-load speed r/min	972	824	269	233	194	152	125	81	67	57	49	36	29	23	19	16	13
额定转速 Rated speed r/min	778	659	215	187	156	122	100	65	54	46	39	29	23	18	15	13	11
额定转矩 Rated torque N.m	1.0	1.2	3.4	3.9	4.7	6.0	7.3	10	12	14	17	22	28	32	39	45	45
最大瞬间允许负载 Max. permissible load in a short time N.m	12	12	50	50	50	50	50	100	100	100	100	100	100	110	110	110	110

配置63ZY125-2450直流电机 (63ZY125-2450 DC Motor)

减速比 Reduction ratio	3.6	4.25	13	15	18	23	28	43	52	61	72	96	121	154	187
减速级数 Number of gear trains	1	1	2	2	2	2	2	3	3	3	3	3	3	4	4
减速器长度(L) Length(L) mm	40.3	40.3	53.8	53.8	53.8	53.8	53.8	67.2	67.2	67.2	67.2	67.2	67.2	80.6	80.6
空载转速 No-load speed r/min	1389	1176	385	333	278	217	179	116	96	82	69	52	41	32	27
额定转速 Rated speed r/min	1111	941	308	267	222	174	143	93	77	66	56	42	33	26	21
额定转矩 Rated torque N.m	1.2	1.5	4.0	4.6	5.5	7.1	8.6	12	14	17	20	27	34	38	45
最大瞬间允许负载 Max. permissible load in a short time N.m	12	12	50	50	50	50	50	100	100	100	100	100	100	110	110

● 电动机特性图 Motor Characteristic Figure

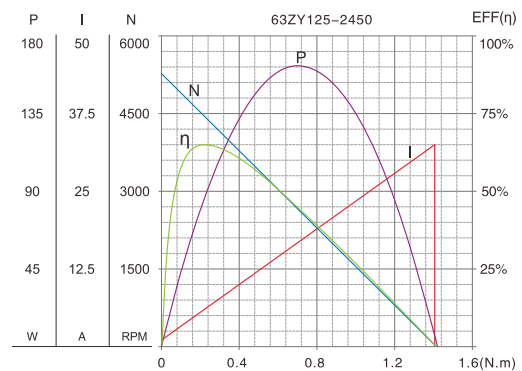
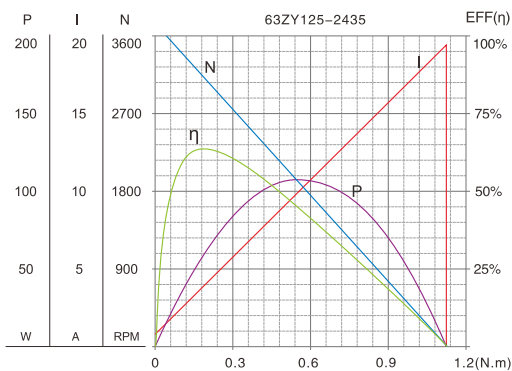

技术参数如有变动, 恕不另行通知