

永磁直行星齿轮(编码器)电机 (内齿圈材质: 金属和粉末金属)

PM DC Planetary Gear Motor (Ring Gear Material: Metal and Powder Metal)

42JXE100K/42ZY68P

Φ42行星减速器, 允许转矩范围: 1N.m~10N.m
42mm OD Planetary Gearbox,
Permissible Load Range: 1N.m~10N.m

可在两种材料的内齿圈中进行选择: 粉末金属 (型号42JXF100K), 金属 (型号42JXE100K)
Ring gear can be selected within the two materials: Powder metal (Type:42JXF100K), Metal (Type:42JXE100K)



电动机主要技术参数 Motor Technical Data

电机型号 Type	额定电压 Rated voltage VDC	空载转速 No-load speed r/min	空载电流 No-load current A	额定转速 Rated speed r/min	额定转矩 Rated torque mN.m	输出功率 Output power W	额定电流 Rated current A	堵转力矩 Stall torque mN.m	堵转电流 Stall current A
42ZY68P-2440	24	4000	0.45	3000	85	27	2.1	250	5.0

电机型号中增加代号P, 表示配置了屏蔽罩, 直径为Φ42.9。 P - Shielding case, OD 42.9mm.

齿轮减速电机主要技术参数 Gear Motor Technical Data

配置42ZY68P-2440直流电机 (42ZY68P-2440 DC Motor)

减速比	Reduction ratio	3.7	5.2	14	19	27	51	71	100	115	139	181	219	254
减速级数	Number of gear trains	1	1	2	2	2	3	3	3	3	3	4	4	4
减速器长度(L)	Length(L)	mm	31.5	31.5	42.1	42.1	42.1	52.5	52.5	52.5	52.5	62.9	62.9	62.9
空载转速	No-load speed	r/min	1078	772	286	211	148	78	56	40	35	29	22	18
额定转速	Rated speed	r/min	809	579	214	158	111	59	42	30	26	22	17	14
额定转矩	Rated torque	N.m	0.31	0.43	1.0	1.4	2.0	3.4	4.8	6.7	7.7	9.3	10	10
最大瞬间允许负载 Max. permissible load in a short time	N.m		3	3	12	12	12	25	25	25	25	25	30	30

外形和安装尺寸 Dimensions

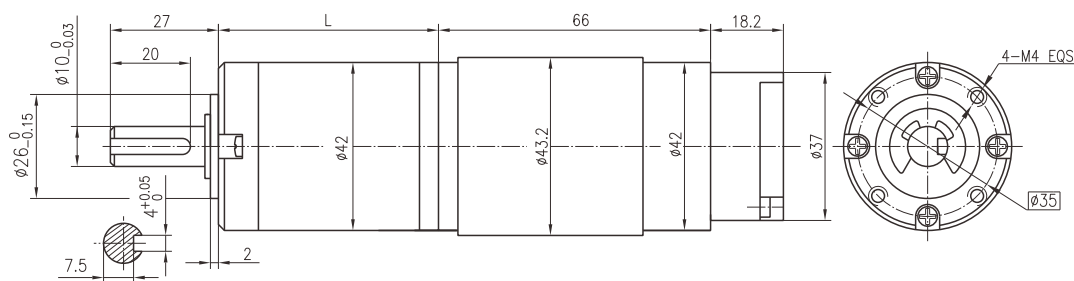

配置磁编码器 Magnetic Encoder

型号: CBM36 输出特性: 2通道, 双向控制, 直流电机旋转一周输出4PPR、7PPR

编码器连接线: 扁平电缆线, 长度350mm

Model: CBM36 output characteristics: 2 channel, two-way control, DC motor rotation a week out of 4PPR、7PPR

Encoder connection: flat cable, length 350mm.

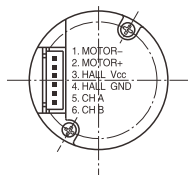

1. MOTOR-
2. MOTOR+
3. HALL SENSOR Vcc
4. HALL SENSOR GND
5. HALL SENSOR A Vout
6. HALL SENSOR B Vout