

混合式步行星齿轮减速电机 (内齿圈材质: 金属)

Planetary Gear Stepping Motor Ring Gear Material: Metal

28JMCS20K/28STH

Φ28 行星减速器, 允许转矩范围: 0.6N.m~2.0N.m
 28mm Planetary Gearbox
 Permissible Load Range: 0.6N.m~2.0N.m

行星齿轮减速器 Planetary Gearbox

输出轴轴承形式 Bearing at output	滚动轴承 Ball bearings	含油轴承 Sleeve bearings
最大允许径向负载 (离法兰 10mm 处) Max. Radial load (10mm from flange)	50N	40N
最大允许轴向负载 Max. shaft axial load	30N	30N
径向间隙 (测量点尽量接近法兰) Radial play of shaft (near to flange)	≤0.08 mm	≤0.1mm
轴向间隙 Axial play of shaft	≤0.3 mm	≤0.3 mm



外形和安装尺寸 Dimensions

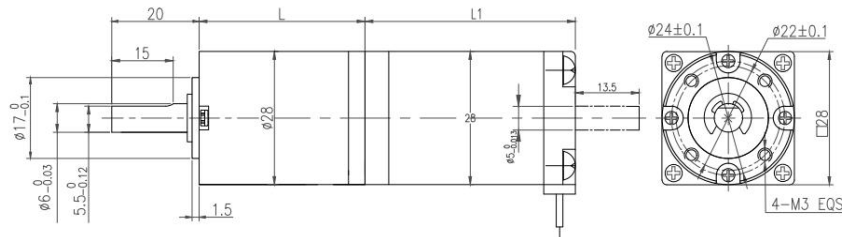

28STH 混合式步进电机性能 28STH Hybrid Stepping Motor Specifications

Model No.	每相电流 Current /Phase	每相电阻 Resistance /Phase	每相电感 Inductance /Phase	保持转矩 Holding Torque	定位转矩 Detent Torque	引出线数 # of Leads	转动惯量 Rotor Inertia	重量 Weight	长度 L1 Length L1
单轴 Single Shaft	A	Ω	mH	N.m	N.m	#	g-cm ²	kg	mm
FL28STH32-0674A	0.67	5.6	3.4	0.060	0.005	4	9	0.11	32 max
FL28STH32-0956A	0.95	2.8	1.0	0.043	0.005	6	9	0.11	32 max

常规产品是单出轴, 可以订货双出轴, 型号的后缀号 A 改为 B。 A-Single Shaft, B-Double shaft

行星减速器性能 Planetary Gearbox Specifications

减速比 Reduction ratio	3.71	5.18	14	19	27	51	71	100	139	
减速级数 Number of gear trains	1			2			3			
减速器长度(L2) Length(L2) mm	22.6			29.2			35.6			
最大额定转矩 Max. rated torque N.m	0.4			1.0			2.0			
瞬间允许转矩 Short time permissible torque N.m	1.2			3.0			6.0			
效率 Efficiency %	90%			81%			73%			
平均背隙(无负载时) Backlash at no-load	0.5°			1.0°			1.5°			
重量 Weight g	68			93			120			

28STH 混合式步进电机矩频曲线 28STH Pull Out Torque Curve

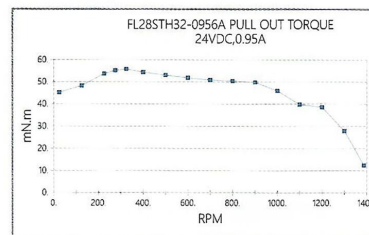
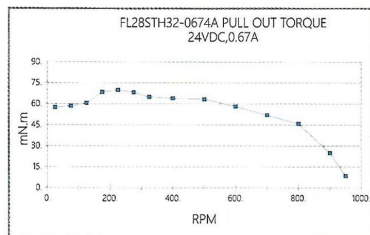

该产品可以根据客户需求定制

The motor can be designed & manufactured with customized request

D-2B (2023)