

# 70JB80K/60ZY105

70JB一体式减速器, 允许转矩范围: 8.0N.m  
70mm Integrated Gearbox,  
Permissible Load Range: 8.0N.m

长寿命减速器, 合金结构钢齿轮, 全部滚动轴承的配置  
Long-lived Gearboxes, Alloy structural steel gears, all using rolling bearings

## ● 外形和安装尺寸 Dimensions

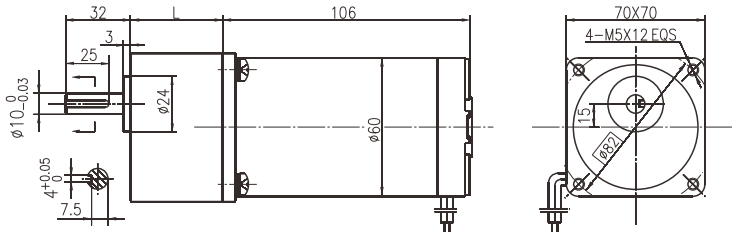

## ● 电动机主要技术参数 Motor Technical Data

电机型号 Type	额定电压 Rated voltage VDC	空载转速 No-load speed r/min	空载电流 No-load current A	额定转速 Rated speed r/min	额定转矩 Rated torque N.m	输出功率 Output power W	额定电流 Rated current A	堵转转矩 Stall torque N.m	堵转电流 Stall current A
60ZY105-2420	24	2000	0.25	1600	0.165	30	1.8	0.76	7.3
60ZY105-2430	24	3000	0.35	2400	0.180	45	2.2	0.79	11.2

## ● 齿轮减速电机主要技术参数 Gear motor Technical Data

配置60ZY105-2420直流电机 (60ZY105-2420 DC Motor)

减速比 Reduction ratio	50	60	75	90	100
减速级数 Number of gear trains	3	4	4	4	4
空载转速 No-load speed r/min	40	33	27	22	20
额定转速 Rated speed r/min	32	26	21	18	16
额定转矩 Rated torque N.m	6.0	6.5	8.0	8.0	8.0
最大瞬间允许负载 Max. permissible load in a short time N.m	8.0	16	16	16	16
转向 Direction of rotation	CCW	CW	CW	CW	CW

配置60ZY105-2430直流电机 (60ZY105-2430 DC Motor)

减速比 Reduction ratio	50	60	75	90	100
减速级数 Number of gear trains	3	4	4	4	4
空载转速 No-load speed r/min	60	50	40	33	30
额定转速 Rated speed r/min	48	40	32	26	24
额定转矩 Rated torque N.m	6.5	7.8	8.0	8.0	8.0
最大瞬间允许负载 Max. permissible load in a short time N.m	8.0	16	16	16	16
转向 Direction of rotation	CCW	CW	CW	CW	CW

## ● 电动机特性图 Motor Characteristic Figure

